

3 Bedrooms / 2 1/2 Baths
Living / Dining / Kitchen / Foyer
Laundry / 3-Car-Garage
(Total 2,720 sq. ft. or 252.7m²)

Upper Floor Plan
(1,510 sq. ft. or 140.3 m²)

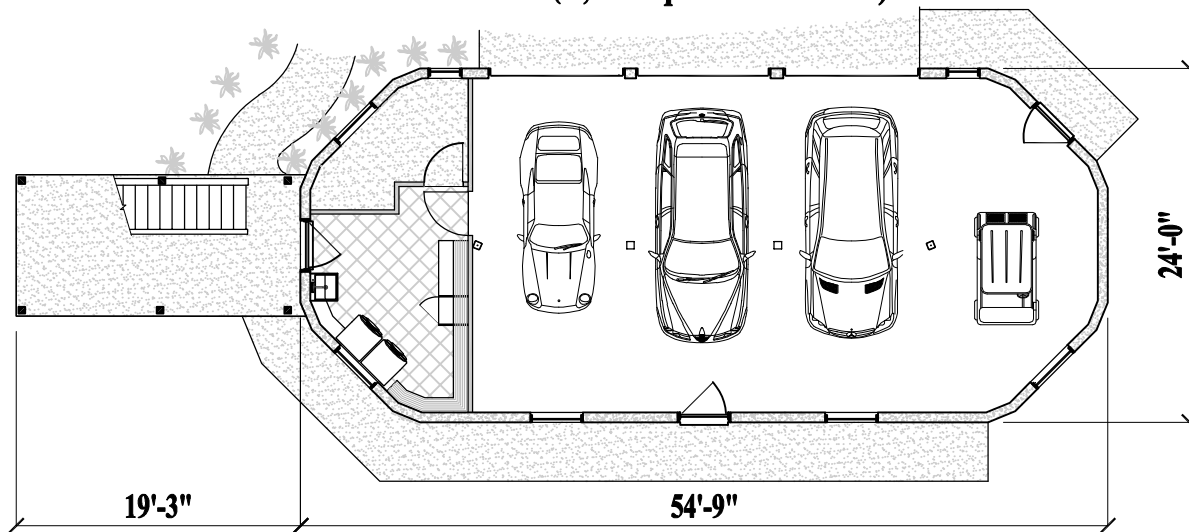

Lower Floor Plan
(Conditioned 230 sq. ft. or 21.4 m²)
Garage 980 sq. ft. or 91 m²)

