

**Floor Plan**  
(2,745 sq. ft. or 255 m<sup>2</sup>)

**3 Bedrooms / 3 1/2 Baths**  
**Living / Dining / Kitchen / Laundry / Foyer**  
**Elevator / Screened Porch / Covered Entry**  
**( Total 3,030 sq. ft. or 281.5m<sup>2</sup> )**  
**( Screened Porch 400 sq. ft. or 37 m<sup>2</sup> )**

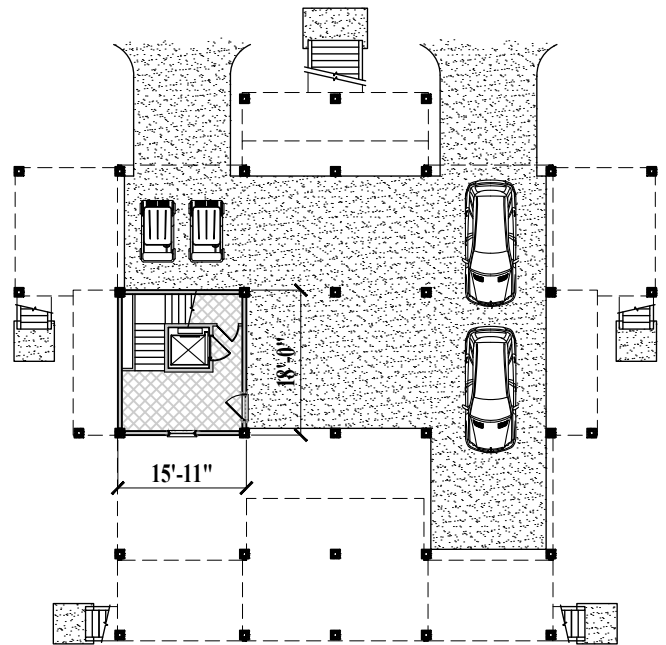

**Ground Level (Parking Area)**  
(285 sq. ft. or 26.5 m<sup>2</sup>)

